



MITCHELLS
REALTY



1 Mungara Court Wondunna QLD

4 2 7

This captivating home (built in 2002) has been well maintained and tastefully refurbished, delivering a flawless blend of indoor and outdoor living with pace for everyone. It is enviably set on a large 2610m2 allotment in a quiet court in the popular Hervey Bay suburb of Wondunna, surrounded by other quality homes. This is where you will also enjoy the convenience of being only a short drive 10-15 minute drive away from Hervey Bay's essential amenities, including schools, aquatic centres, sporting grounds, shopping centres, Bunnings, hospitals, the esplanade, and the beach.

Upon entering this home, the scale and quality are immediately apparent, flaunting an enviable, innovative design with seamless space transitions coupled with large tinted windows, new rolla-blinds and neutral colour tones. These open and connected spaces allow light and air to fill this home naturally with a coveted North/South aspect for year-round entertaining.

1 Mungara Court Wondunna features: -

- 2610m2 corner allotment offering two street access
- Modern well maintained brick-rendered home with tile roof completed in 2002
- New window coverings (rolla blinds)
- Four spacious bedrooms, all with built-in wardrobes and ceiling fans
- The main bedroom and guest's bedroom both have split system air conditioning
- The main bedroom includes a walk-in wardrobe and a lavish ensuite
- The bathroom includes a bath, shower and vanity
- A separate powder room and toilet

- There is also a separate study or home office
- The kitchen includes ample bench and storage space, plus a pantry
- Quality appliances include a 5-burner gas cooktop, range hood, oven and new Bosch dishwasher
- An open-plan dining area leads off the kitchen and offers direct access to the outdoor area
- Separate lounge or media room with gas fireplace and direct access out to entertaining area
- A fantastic double-insulated / covered alfresco outdoor entertaining area
- Solar-heated in-ground pool with spa bath, BBQ hut and bar
- Large laundry with direct access to an outdoor clothesline
- Tinted windows and security screen throughout
- Double garage with remote panel lift door and internal access
- 12 x 9 metre - 2 bay shed with workshop, mezzanine storage, power & water
- 10.5 x 4.5-metre single bay shed with high 3.6-metre entry and power and water connected
- Plenty of space to accommodate large caravans and boats
- Great selection of established fruit and citrus trees
- 3.6kw solar power system and rainwater tank

Homes offering these features are always in high demand - so don't miss this opportunity to secure this one!

Contact our team now to arrange your private inspection - you will only be disappointed if you miss out on this one?

NOTE: Property boundary lines are shown as approximate/indicative only in associated images - Please refer to survey plans for full details.

DISCLAIMER: Whilst every effort has been made to ensure the accuracy and thoroughness of the information provided to you in our marketing material, we cannot guarantee the accuracy of the information provided by our vendors, and as such, Mitchells Realty makes no statement, representation or warranty, and assumes no legal liability in relation to the accuracy of the information provided. Interested parties should conduct their own due diligence in relation to each property they are considering purchasing. All photographs, maps, and images are representative only for marketing purposes.

Price : \$ 985,000
Land Size : 2610 sqm
View : <https://www.mitchellsrealty.com.au/property/1-mungara-court-wondunna-qld/7942327>



Scott & Katrina Mitchell
0428 484 499

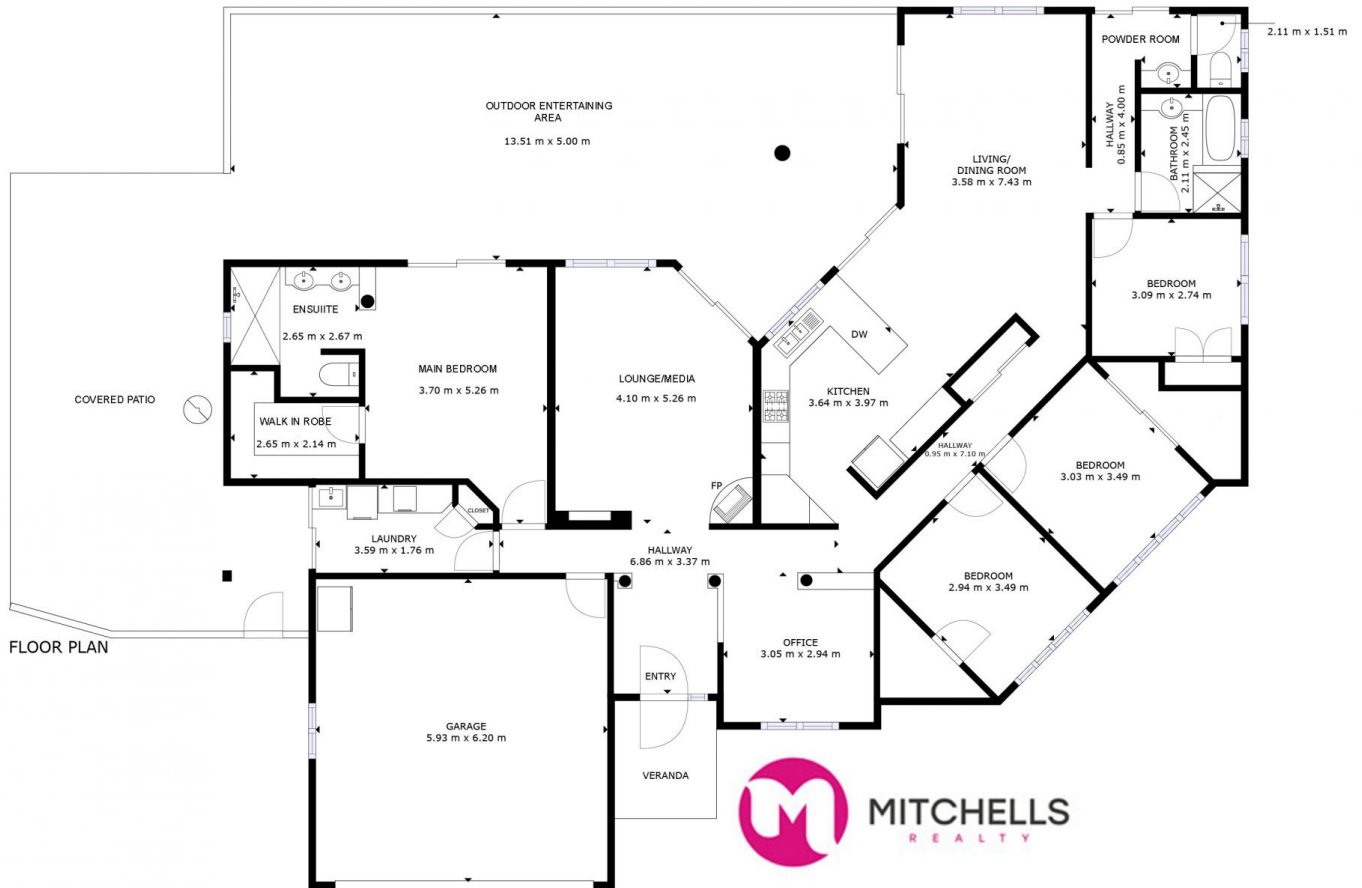

GROSS INTERNAL AREA
FLOOR PLAN: 170 m²
EXCLUDED AREA: GARAGE: 36 m², PATIO: 69 m²
SIZES AND DIMENSIONS ARE APPROXIMATE, ACTUAL MAY VARY.

